

GLASS DOOR KNOB

MWO 020A

Ø45 Round Recess Knob (Polished)

For use with glass door of 10-12mm thick.
A glass notch cut-out is required for installation.



Glass Cutout

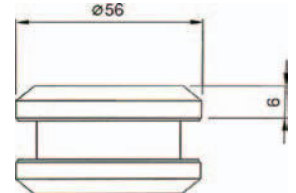
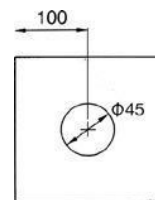

MWO 020

Ø45 Round Recess Knob (Satin)

For use with glass door of 10-12mm thick.
A glass notch cut-out is required for installation.



Glass Cutout

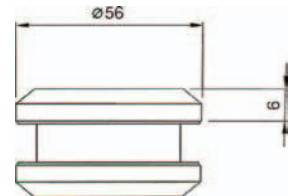
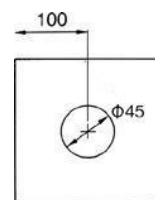

MWO 022

Cylindrical Door Knob (Polished)

For use with glass door of 10-12mm thick.
A glass notch cut-out is required for installation.



Glass Cutout

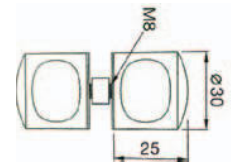
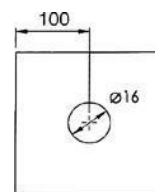

MWO 023

Spherical Door Knob (Polished)

For use with glass door of 10-12mm thick.
A glass notch cut-out is required for installation.



Glass Cutout

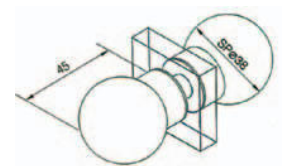
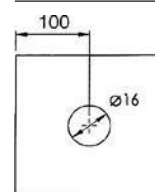

MWO 025

Button Door Knob (Polished)

For use with glass door of 10-12mm thick.
A glass notch cut-out is required for installation.



Glass Cutout

